

Hardtop line

# 410 HTC

COMING  
SOON



The upcoming 410 HTC based on the hull of the successful 400 FLY presents a more sporty silhouette matched by its quality interior. The hardtop offers a large glass sunroof over the helm station. The sizable tarpaulin roof, 410 HTC's new prominent feature, covers the cockpit from the sunlight during the voyage and opens with a touch of a button – an ingenious solution!

The foredeck offers a sun lounge response for the abundance of space for leisure and activities. A clever integrated wet bar area on a platform ensures many amazing moments with family and friends. The incredible and everyone's favourite feature - the "Beach Mode" allows the use of the added deck space for entertaining and relaxation.

The main deck has a full featured galley with plenty of space for dining, a rotating aft sofa and a comfortable saloon with a large three segment entrance door to the expansive cockpit. Down below both the owner and guest cabins contain double beds and ensure total privacy. Two bathrooms are complete with a sink, a shower and a toilet. Select from a variety of interior finishes and additional equipment to fully customize your yacht.

The 410 HTC brings a breath of fresh air to the hardtop line category. The new model offers exciting performance and flawless design as expected from a fourth generation model. The yacht's standard version is powered with twin Volvo Penta engines. Join the Galeon Yachts family, where many amazing memories will be made!

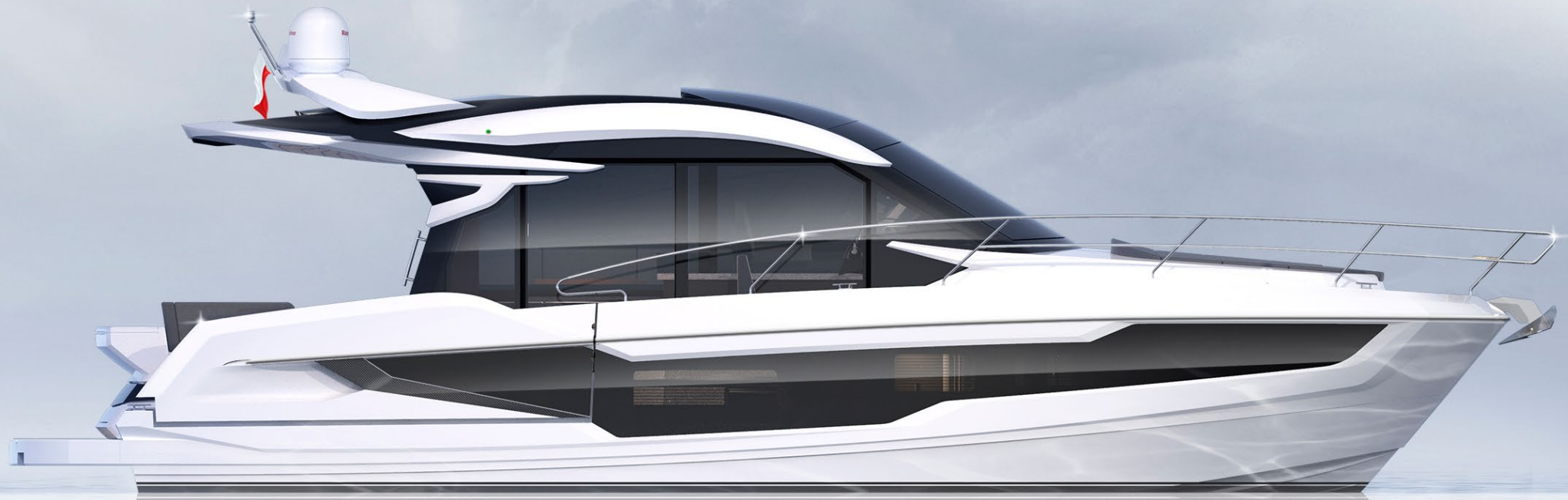



## 410 HTC

The tarpaulin roof, which covers the cockpit from the sunlight during the voyage, opens with a touch of a button!

# 410 HTC

# THE POWER OF HARDTOP

## LAYOUTS

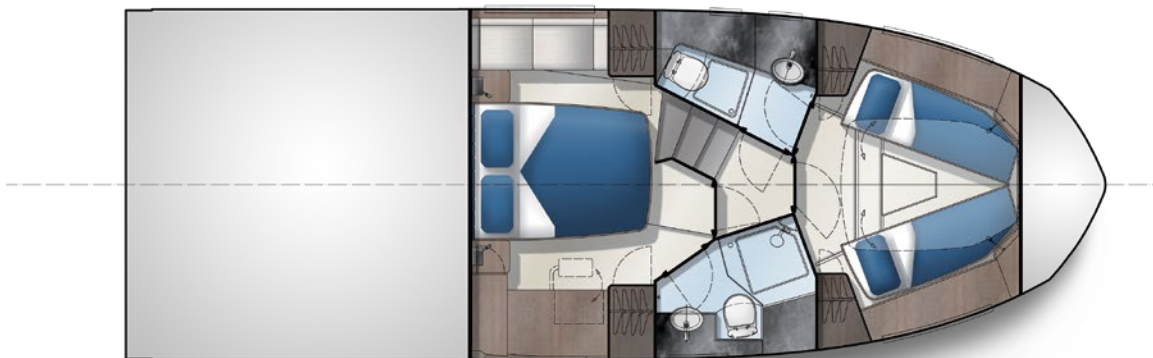
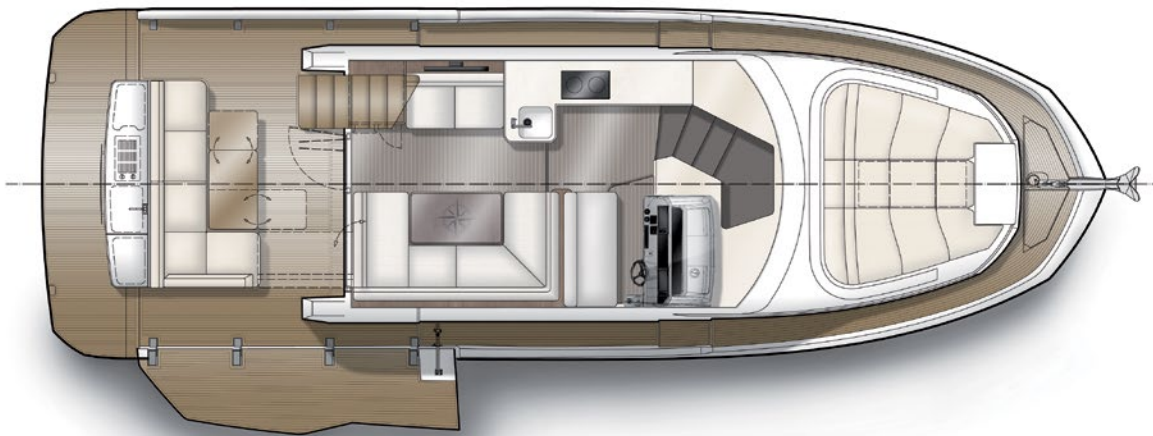

## TECHNICAL SPECIFICATION

Length of the hull	[m]	11,08
Length overall	[m]	12,48
Beam of the hull	[m]	3,94
Beam overall	[m]	3,95
Draft max <sub>1</sub>	[m]	0,90
Bridge clearance <sub>2</sub>	[m]	TBD
Height to transport	[m]	TBD
Fuel tank capacity	[dm <sup>3</sup> ]	2 x 500
Water tank capacity	[dm <sup>3</sup> ]	450
Grey water tank	[dm <sup>3</sup> ]	160
Black water tank	[dm <sup>3</sup> ]	130
Mass of Light Craft Condition <sub>3</sub>	[kg]	TBD
Maximum Load	[kg]	TBD
Min. engine (-s) power	[kW/hp]	2 x 198 / 270
Max. engine (-s) power	[kW/hp]	2 x 324 / 440
Crew limit		12
Category		B

<sub>1</sub> - without propellers    <sub>2</sub> - Max. height from water line at draft min.    <sub>3</sub> - minimum mass with base engines  
\* - with extended stern platform

