

405 HTS



The new 13,5-meter, hardtop yacht designed by Tony Castro Yacht Design has been created and built to be a perfect day cruiser for all the sport enthusiasts. Its exterior styling and interior arrangement reveal the Galeon's classic profile with a modern twist. The yacht's interior has been designed to be bright and welcoming with functionality and balanced layout. Materials include carefully selected veneers, Corians, high quality fabrics and matte or mirror-gloss finish wood.

Large windows add natural light to the saloon, galley and guest's cabins. A vast saloon on the main deck with a starboard side bar is sure to become a popular gathering area for family and friends, giving them the feeling of space. The helm benefits from large windows and a single pane windshield that provide 360-degree panoramas. Accommodation space on the lower deck features a full featured galley and two staterooms with separate bathrooms, to ensure guests' comfort and privacy. The owner's suite is located midship and occupies the whole width of the yacht allowing for an incredible amount of volume and storage space.

The extended roof over the cockpit area provides additional protection from the sun. The cockpit space with an outdoor kitchen, a dining table and sunbed conversions gives extra space for gatherings. The yacht offers an extended bath platform with easy access to a garage storage for the toys. The bow settee area designed for entertainment makes a lovely hideaway. A very interesting feature of this yacht is a tarpaulin roof that swiftly morphs into the wide opening sunroof over the helm station. Just press a button and enjoy the fresh breeze and sunshine!

Sportcruiser line

The 405 HTS is sophisticated but functional as well as elegant and cozy. This luxury motor yacht is a breath taking hardtop model with a bright and airy interior and it brings you an unforgettable experience. Find your new paradise with Galeon Yachts!



405 HTS

This is the essence of a modern classic with a sporty line.





405 HTS

The aft sofa, which changes into a sunbathing area in one move and the wet bar next to it will be guests' favorite places

405 HTS

A sliding glass roof with an option to shade it will make every cruise even more pleasant.



405 HTS

FLAWLESS PERFORMANCE

LAYOUTS

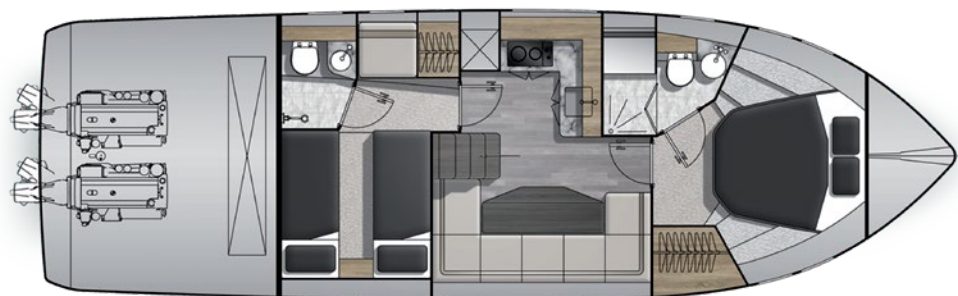
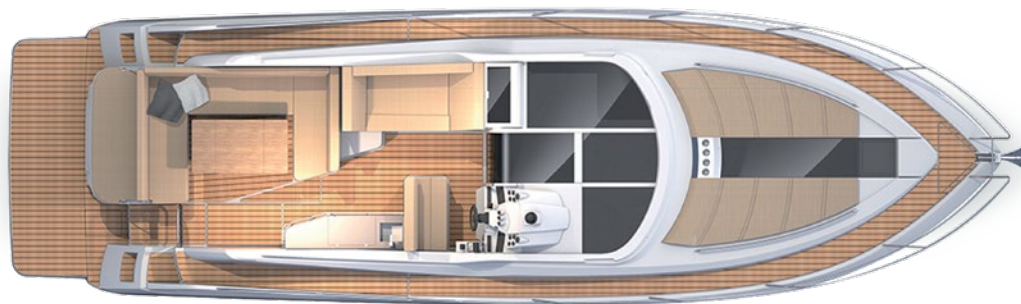

TECHNICAL SPECIFICATION

Length of the hull	[m]	11,99
Length overall	[m]	13,46
Beam of the hull	[m]	3,84
Beam overall	[m]	3,90
Draft max ₁	[m]	TBD
Bridge clearance ₂	[m]	TBD
Height to transport	[m]	4,56
Fuel tank capacity	[dm ³]	950
Water tank capacity	[dm ³]	450
Grey water tank	[dm ³]	250
Black water tank	[dm ³]	160
Mass of Light Craft Condition ₃	[kg]	TBD
Maximum Load	[kg]	TBD
Min. engine (-s) power	[kW/hp]	2 x 169 / 230
Max. engine (-s) power	[kW/hp]	2 x 279 / 380
Crew limit		10
Category		B

₁ - without propellers ₂ - Max. height from water line at draft min. ₃ - minimum mass with base engines
 * - with extended stern platform

